

PLAN SHOWING THE PROPOSED SUB DIVISIONS IN S No 637/3A OF  
 89, AMBATTUR VILLAGE, AMBATTUR TOWN SHIP, SAIDAPET TALUK  
 CHENGAI-MGR DISTRICT.

SCALE: 1" = 33'-0" (1:400)

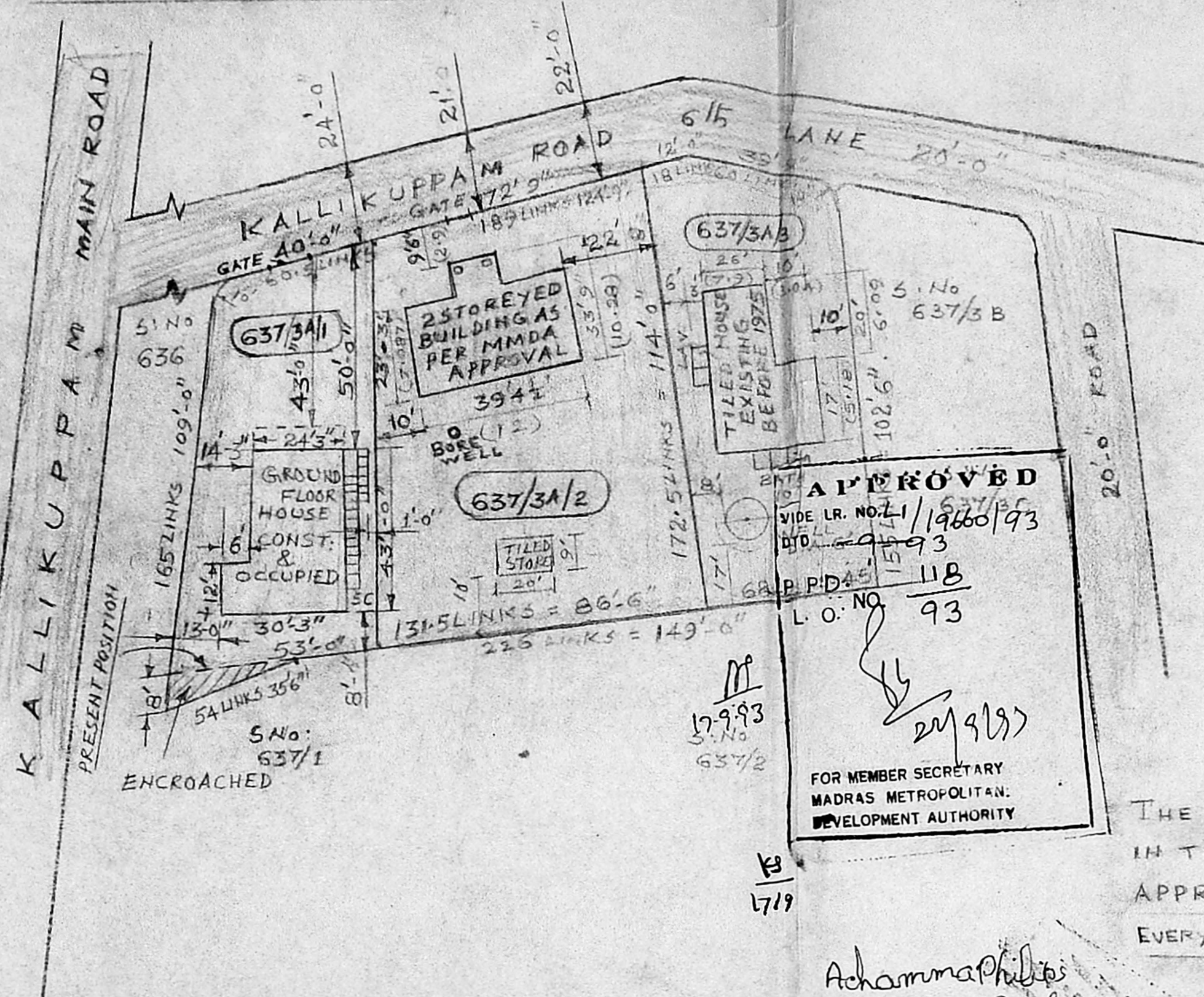
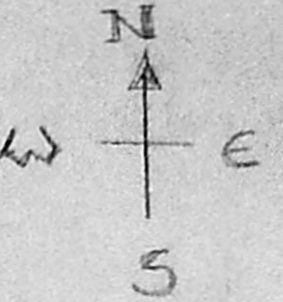

**APPROVED**  
 VIDE LR. NO. 11/19660/93  
 DTD 15/9/93  
 P.P.D. No 118  
 L.O. NO 93  
 FOR MEMBER SECRETARY  
 MADRAS METROPOLITAN  
 DEVELOPMENT AUTHORITY

M  
 17-9-93  
 S.No  
 637/2  
 B  
 17/9

Achamma Philips  
 Ramani Philips  
 OWNER



TOPO PLAN  
 NOT TO SCALE

REFERENCE

| S.No              | AREA SQ: FEET | SQ: MB      |
|-------------------|---------------|-------------|
| S.No. 637/3A/1    | 5057          | = 470       |
| S.No. 637/3A/2    | 9102          | = 846       |
| S.No. 637/3A/3    | 5324          | = 495       |
| <b>TOTAL AREA</b> | <b>19483</b>  | <b>1811</b> |

THE SUBDIVISION OF LAND IN S.No 637/3  
 IN TO 637/3A, 637/3B & 637/3C WAS  
 APPROVED BY MMDA VIDE: PPD No 63/88 dt 15-5-88  
 EVERY PART & PARCEL OF LAND IN S.No 637/3A OWNED BY OWNER.

M  
 V. Rajaraman, L.S.D.  
 Civil Engineer &  
 Licensed Surveyor  
 Ambattur & Avadi Townships  
 210/5, M.T.H. ROAD  
 VENKATAPURAM  
 AMBATTUR, MADRAS-52